



GHURA

Guam Housing and Urban Renewal Authority
Aturidat Ginima' Yan Rinueban Siudad Guahan
117 Bien Venida Avenue, Sinajana, GU 96910
Phone: (671) 477-9851 Fax: (671) 300-7565 TTY: (671) 472-3701
Website: www.ghura.org



UNIT FOR RENT FORM SUBMISSION

This form is posted in GHURA's Units for Rent Binder. Rental information is posted on www.ghura.org within 3 business days.

DATE: 02/09/2020 GHURA RECEIVED: _____

LANDLORD INFORMATION

NAME: RAM TRASEN PHONE #: (671) 480-8194

EMAIL: ram.reguam@gmail.com ALTERNATE #: ()

ABOUT THE UNIT

RENT PER MONTH: \$ 2400.00 BEDS: 3 BATHS: 2 SQ FT: 1000 YR BUILT: 1979

DATE UNIT AVAILABLE: 03 15 2020
MONTH DAY YEAR

UNIT ADDRESS: 125 UNIT A JOSEPH LANE MANGILAO 96913
STREET ADDRESS VILLAGE ZIP CODE

TYPE OF UNIT:

- | | |
|--|---|
| <input type="checkbox"/> Single House Detached | <input type="checkbox"/> Low Rise Apartment (3-4 stories) |
| <input checked="" type="checkbox"/> Duplex | <input type="checkbox"/> High Rise Apartment (5+ stories) |
| <input type="checkbox"/> Row House or Town House (1-2 stories) | <input type="checkbox"/> Other: _____ |

BASIC APPLIANCES PROVIDED BY LANDLORD:

- | | |
|--|---|
| <input checked="" type="checkbox"/> Refrigerator | <input type="checkbox"/> Air Conditioner (not required) |
| <input checked="" type="checkbox"/> Stovetop / Range | <input type="checkbox"/> Washer / Dryer (not required) |
| <input checked="" type="checkbox"/> Water Heater | <input type="checkbox"/> Other: _____ |

UTILITIES PAID BY LANDLORD:

- | | |
|---|---|
| <input checked="" type="checkbox"/> No Utilities (paid by tenant) | <input type="checkbox"/> Some Utilities (list utilities covered by landlord): _____ |
| <input type="checkbox"/> All Utilities | |

ADA (AMERICANS WITH DISABILITY ACT) AMENITIES:

- | | |
|--|---------------------------------------|
| <input type="checkbox"/> Wheelchair Accessible | <input type="checkbox"/> Other: _____ |
| <input type="checkbox"/> Sight Impairment Accessible | |

SEE UNIT MAP ON BACK



GHURA will not steer families to select a certain unit as it is prohibited under the Section 8 Program, but it will educate and advise families on how to select a suitable unit and how to be a good tenant through basic practices of being a good renter.

REC'D SECTION 8
FEB 9 '20 PM 12:50

UNIT LOCATION MAP

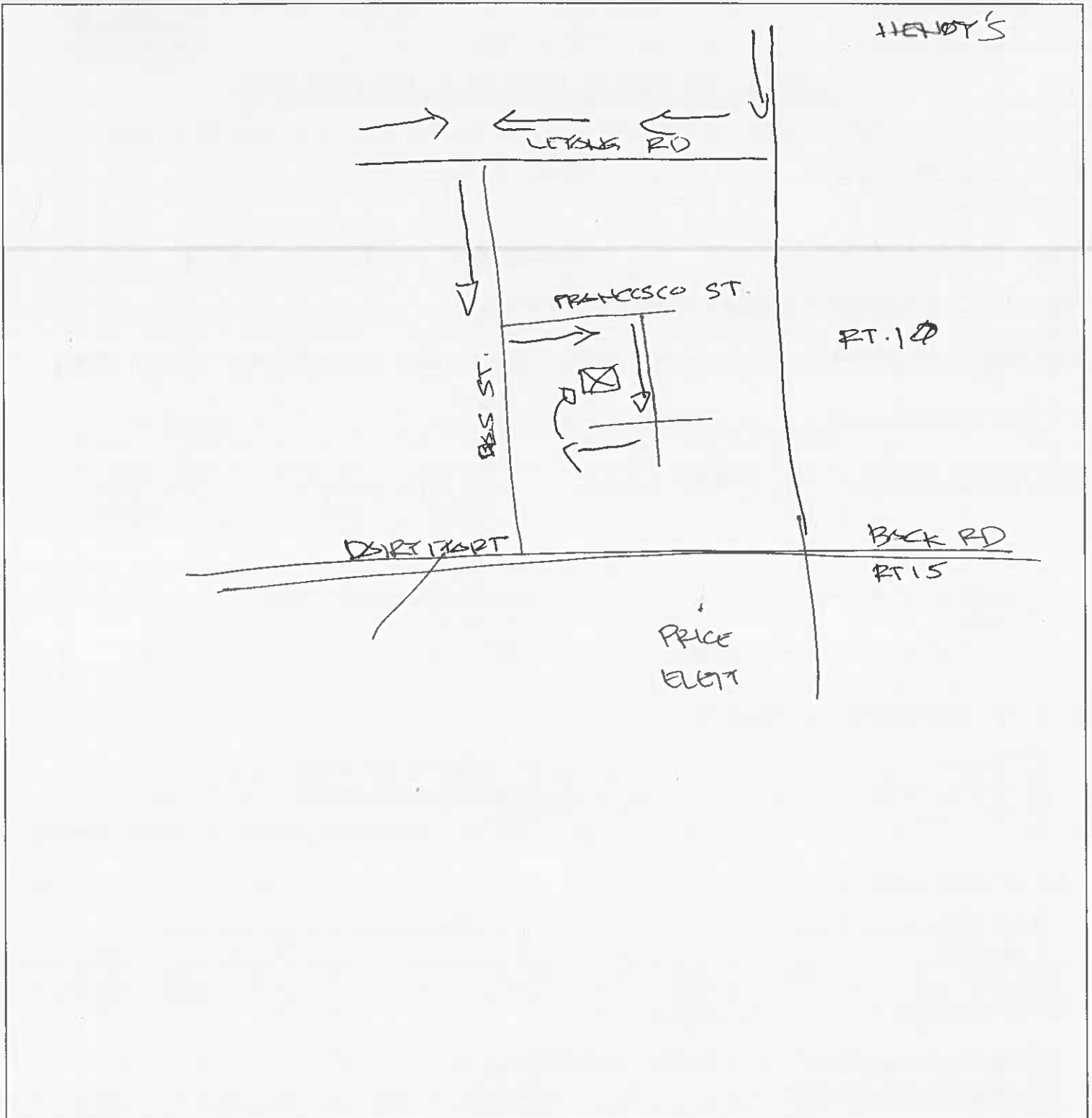

GHURA will not steer families to select a certain unit as it is prohibited under the Section 8 Program, but it will educate and advise families on how to select a suitable unit and how to be a good tenant through basic practices of being a good renter.